

Vancouver, BC

In the fall 2005, UBC Land & Building Services commissioned CAGP to undertake a feasibility study to determine the potential for locating a new 120,000 GSF building for the Faculty of Law on the Faculty's current site in the NE corner of the campus, close to the Chan Centre and newly-established residential 'Theological Neighbourhood'. Relying on a functional program prepared in June 2005 by Resource Planning Group (RPG), the study was to also consider strategies for inclusion or redevelopment of the c. 1973 two-storey concrete structure designed for Law by the noted Vancouver architect, Fred Hollingsworth.

Multiple planning options were developed, responding to RPG's functional program and site constraints. It became apparent through the working process that Law was attached to this exceptional campus location but not to their current facilities, preferring an entirely new and separate building to meet new teaching and learning needs. Planning options were also developed for retrofitting the existing 1973 building as UBC 'swing space', made up of generic classrooms and offices. Working with engineering and cost consultants, 'global budgets' were developed for final design options in the range of \$80-100M (escalated to 2008-2010) with recommendations made on next steps for the project to proceed through UBC's approval process.

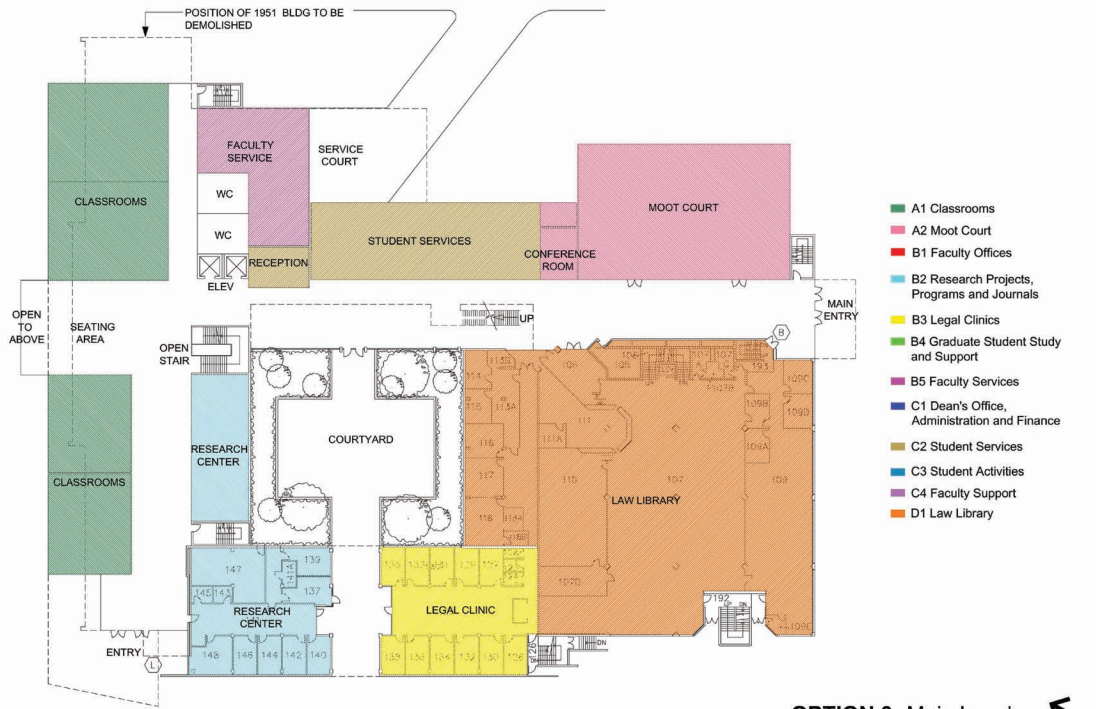

OPTION 3- Main Level



OPTION 3 - Second Level

Client/Contractor:
UBC Land & Building Services

Programme:
120,000 GSF building for the Faculty of Law on the Faculty's current site.

Construction Estimate:
\$80-100M as 'global budget', 2008-2010.

Site:
NE Corner of UBC Campus, close to the Chan Centre and newly-established residential 'Theological Neighbourhood'.