

ESSB Study, UBC

Recently commissioned by Partnerships BC in collaboration with UBC Land & Building Services, The Colborne Architectural Group along with a full consulting team has been requested to review program requirements, site planning constraints and opportunities and potential costs for this proposed new high-tech science research building to be located on the west side of Main Mall, across from the newly developed Beaty Biodiversity Centre and AERL Buildings. The 14,570 gsm multi-storey building will house specialized research and teaching labs, classrooms, offices and technical support space for Faculty of Science/Earth & Ocean Science programs as well as Pacific Institute for Mathematical Science (PIMS), Statistics and new offices for the Dean of Science. The ESSB building must fully integrate with the existing EOS Main and South buildings to remain and become both an activity generator and backdrop for 'Fairview Square', a major new student-focused open space proposed to anchor the Science precinct along UBC's Main Mall.

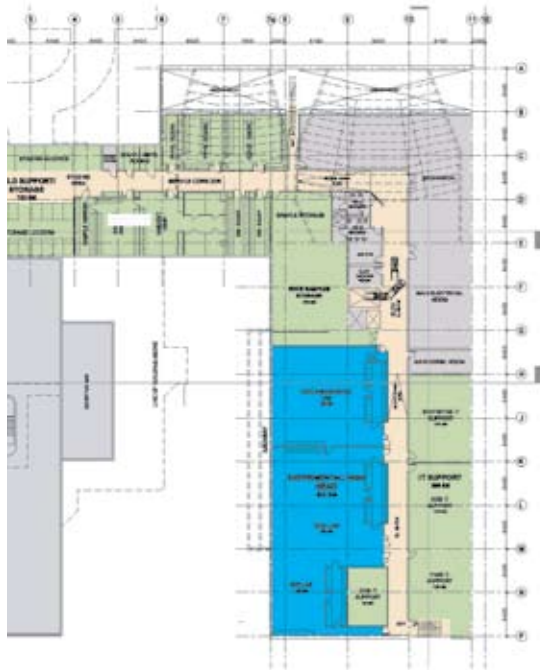

LOWER LEVEL PLAN



MAIN LEVEL PLAN



SECOND LEVEL PLAN



THIRD LEVEL PLAN

